

MERIDIAN
 LAMBERT GRID NORTH WASHINGTON STATE COORDINATE SYSTEM
 OF NAD 1983/91 - SOUTH ZONE

NOTE
 ALL DISTANCES AS SHOWN HEREON ARE GRID AND BASED ON
 A COMBINED SCALE FACTOR OF 0.9998681

LEGEND
 (C) CALCULATED
 (R1) REFERENCE RECORD OF SURVEY, REC. NO. 199612040031
 (R2) REFERENCE RECORD OF SURVEY, REC. NO. 200209130026
 NOTE: GROUND DISTANCES PER REFERENCE SURVEYS HAVE BEEN
 CONVERTED TO GRID DISTANCES

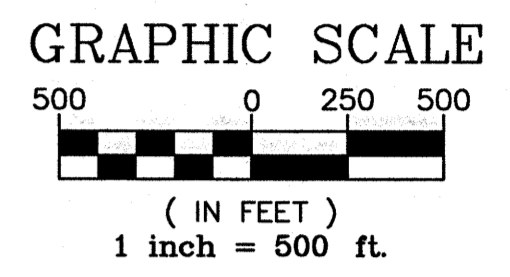

OLD LEGAL DESCRIPTION
 THAT PORTION OF SECTION 27, TOWNSHIP 21 NORTH, RANGE 14 EAST, W.M., KITTITAS COUNTY, STATE OF WASHINGTON, LYING NORTHEASTERLY OF THE CENTERLINE OF SALMON LA SAC ROAD.

- NEW LEGAL DESCRIPTIONS**
- LOT 1
 THE SOUTHWEST QUARTER OF SECTION 27, TOWNSHIP 21 NORTH, RANGE 14 EAST, W.M., KITTITAS COUNTY, STATE OF WASHINGTON, LYING NORTHEASTERLY OF THE CENTERLINE OF SALMON LA SAC ROAD;
 EXCEPT THE NORTH 430.00 FEET THEREOF;
 AND EXCEPT THE EAST 50.00 FEET THEREOF.
- LOT 2
 THE NORTHWEST QUARTER OF SECTION 27, TOWNSHIP 21 NORTH, RANGE 14 EAST, W.M., KITTITAS COUNTY, STATE OF WASHINGTON;
 EXCEPT THE NORTH 1520.00 FEET THEREOF;
- TOGETHER WITH THE NORTH 430.00 FEET OF THE SOUTHWEST QUARTER OF SECTION 27, TOWNSHIP 21 NORTH, RANGE 14 EAST, W.M., KITTITAS COUNTY, STATE OF WASHINGTON;
 EXCEPT THE EAST 50.00 FEET THEREOF.
- LOT 3
 THE NORTH 1520.00 FEET OF THE NORTHWEST QUARTER OF SECTION 27, TOWNSHIP 21 NORTH, RANGE 14 EAST, W.M., KITTITAS COUNTY, STATE OF WASHINGTON.
- LOT 4
 THE NORTHEAST QUARTER OF SECTION 27, TOWNSHIP 21 NORTH, RANGE 14 EAST, W.M., KITTITAS COUNTY, STATE OF WASHINGTON;
 EXCEPT THE EAST 1325.00 FEET THEREOF.
- LOT 5
 THE EAST 1325.00 FEET OF THE NORTHEAST QUARTER OF SECTION 27, TOWNSHIP 21 NORTH, RANGE 14 EAST, W.M., KITTITAS COUNTY, STATE OF WASHINGTON.
- LOT 6
 THE EAST 1345.00 FEET OF THE SOUTHEAST QUARTER OF SECTION 27, TOWNSHIP 21 NORTH, RANGE 14 EAST, W.M., KITTITAS COUNTY, STATE OF WASHINGTON.
- LOT 7
 THE SOUTHEAST QUARTER OF SECTION 27, TOWNSHIP 21 NORTH, RANGE 14 EAST, W.M., KITTITAS COUNTY, STATE OF WASHINGTON;
 EXCEPT THE EAST 1345.00 FEET THEREOF;
 TOGETHER WITH THE EAST 50.00 FEET OF THE SOUTHWEST QUARTER OF SAID SECTION 27.

LINE	BEARING	LENGTH
L1	N30°03'36"W	103.36'
L2	N30°25'51"W	149.15'
L3	N32°05'05"W	99.99'
L4	N33°50'25"W	50.85'
L5	N59°52'46"W	10.26'
L6	N61°49'38"W	149.98'
L7	N63°54'04"W	139.74'
L8	N63°18'39"W	113.00'

PRELIMINARY

SEC. 27, T. 21 N, R. 14 E, W.M.

RECORDER'S CERTIFICATE
 Filed for record this ____ day of ____ 20__ at ____M
 in book ____ of ____ at page ____ at the request of
DAVID L. HILL

 Mgr. Supt. of Records

SURVEYOR'S CERTIFICATE
 This map correctly represents a survey made by me
 or under my direction in conformance with the
 requirements of the Survey Recording Act at the
 request of ANSELMO LAND CO., LLC in JUN, 2012
 Signature _____ Certificate No. 28101

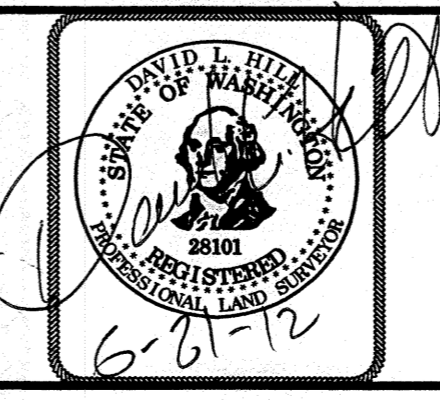

K.C.C. 16.08.015
ADMINISTRATIVE
SEGREGATIONS
FOR
ANSELMO LAND CO., LLC

CONCEPT ENGINEERING, INC. 455 Rainier Boulevard North Issaquah, Washington 98027 (425) 392-8055 FAX (425) 392-0108 <small>Copyright © 2007 Concept Engineering, Inc. All rights reserved.</small>		
DWN. BY DBM	DATE 6/18/12	JOB NO. 32049
CHKD. BY	SCALE 1" = 500'	SHEET 1 OF 1